

NDM Pumps

Stainless Steel ISO2858 Magnetic Drive Pumps

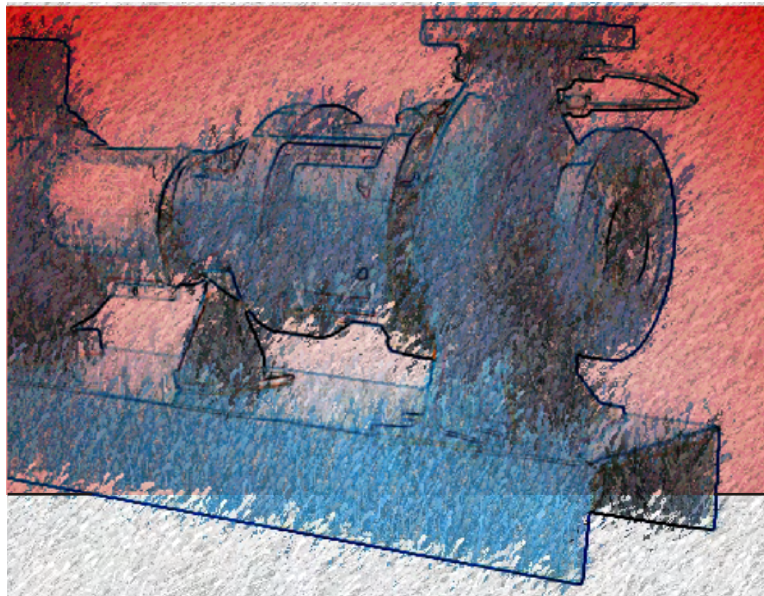

The NDM range of magnetically driven pumps is designed to ISO 2858. They have been designed with a hydraulically balanced impeller to achieve high pumping efficiency and low NPSH capabilities.

Reliable and Long Lasting

With no shaft seals, liquid cannot seep into the motor from the pump. The NDM pump design has seen over 25 years service around the world in all manner of applications.

Built-in Overload Protection

If overloaded, the magnetic coupling breaks drive to provide protection for the motor from burn-out.

High Temperature Compatible

Many of the pumps can be configured to pump liquids up to 300°C . For temperatures over 300°C an external heat exchanger can be fitted.

Easily Maintained

The pump head can be easily dis-assembled and components quickly replaced.

Technical Support

March May has over 30 years experience in the field of magnetic drive pumps.

Self Cleaning Filters

NDM pumps are available with self cleaning filters to enable them to handle liquids with some degree of soft solids.

Caster Equivalent

The NDM range of pumps will directly replace original MCA pumps.

Design Flexibility

The NDM range have many optional extras including heat jackets, flow inducers, heat exchanges, and alternatives construction materials.

They are also available in either close or long coupled configurations

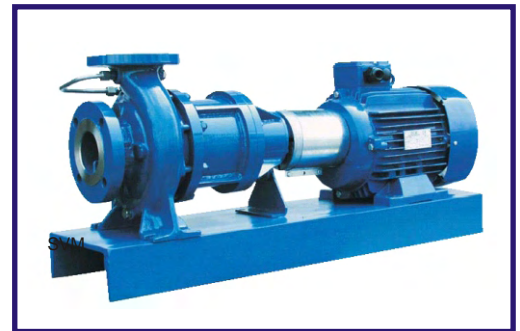

All versions of the pumps can be ATEX approved to Equipment Category 2, (Gas Zone 1 and Dust Zone 21) and temperature rating T4.

PERFORMANCE

50 Hz, SG 1.0

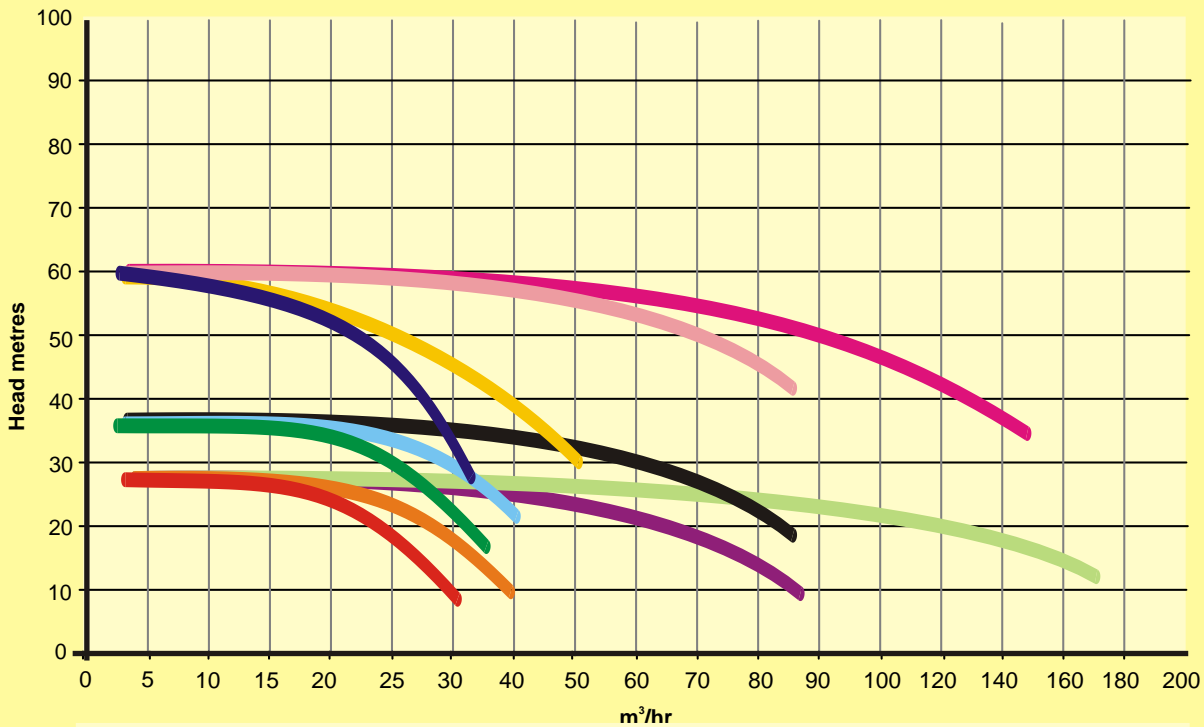

- NDM 8x5x20
- NDM 6x4x20
- NDM 6x5x16
- NDM 5x3x16
- NDM 8x6x16
- NDM 10x6x20
- NDM 6x5x12
- NDM 5x3x12
- NDM 8x6x12
- NDM 10x8x12
- NDM 5x3x20

All figures are indicative, please consult March May Lt for exact performances.

Dimensions

Dimensions in mm not to scale specifications are subject to change

Model	Inlet mm	Outlet mm	a mm	h1 mm	h2 mm	f1 mm	(f2) mm
5x3x12	50	32	80	112	140	225	245
5x3x16	50	32	80	132	160	225	245
5x3x20	50	32	80	160	180	225	245
6x5x12	65	50	80	112	140	225	245
6x5x16	65	50	80	132	160	225	245
6x4x20	65	40	100	160	180	225	245
8x6x12	80	65	100	132	160	225	245
8x6x16	80	65	100	160	180	225	245
8x 5x20	80	50	100	160	200	225	245
10x8x12	100	80	100	180	225	225	245

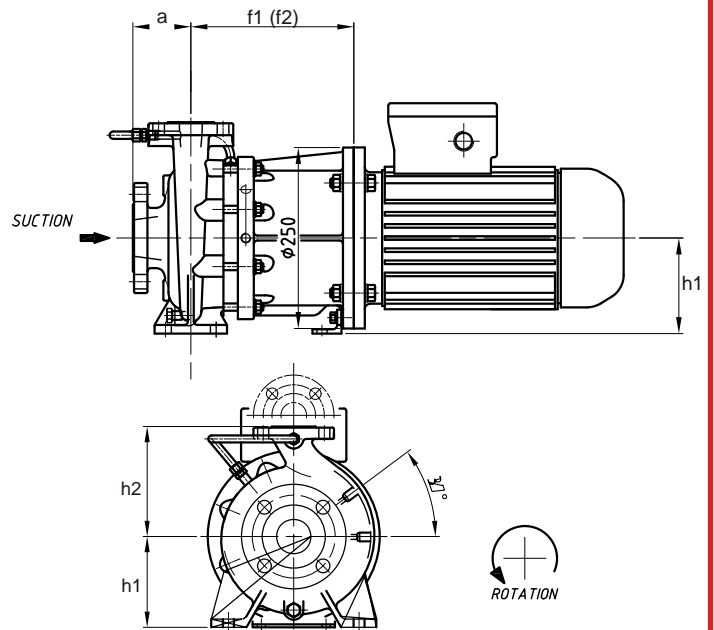

Technical

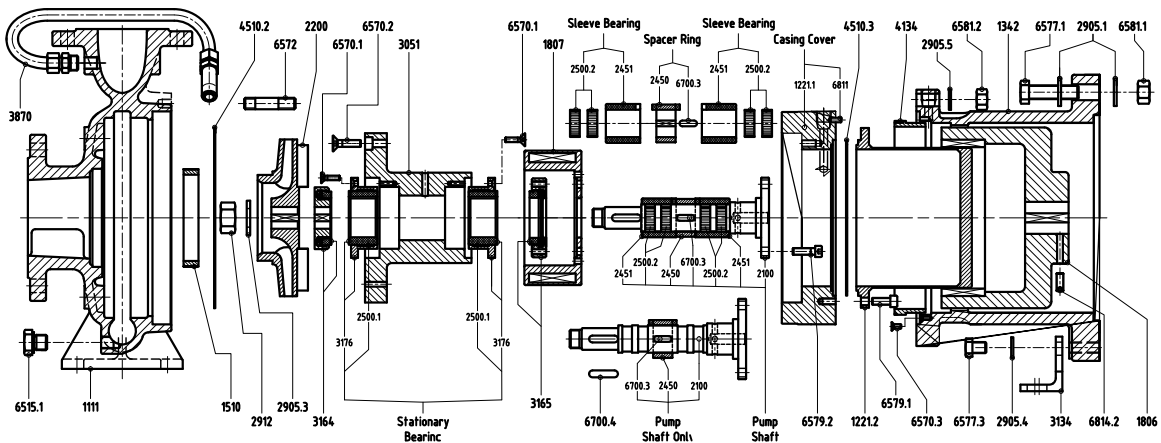

REF	DESCRIPTION	N. Q.T.	MATERIAL	CODE	REF	DESCRIPTION	N. Q.T.	MATERIAL	CODE
1111	Pump Casing	1	ASTM CF8M	8M018231	▲ 4510.2	Body Gasket	1	AF 1600	8M30820T
	Casing Cover	1		8M028201	4510.3	Rear Casing Gasket	1	AF 1600	8M31810T
	1221.1 Casing Cover Pin	1	AISI 316L / AISI 304		6515.1	Drain Plug	1	AISI 316	8M328101
1221.2	Rear Casing	1	AISI 316L / HC276	8M038101	6572	Stud Nut	8	AISI 316	8M348200
1342	Bracket	1	ASTM A45 cl 30	8M04810GA0000	6579.1	Screw	12	AISI 316	8M358101
■ 1510	Casing Wear Ring	1	AISI 316	8M058101	6700.4	Pump Shaft Key	2	AISI 316	8M388101
▲ 1806	Outer Magnet	1	Neodym./Steel	8M06810N0004	▲ Set Internal Screws				8M408101
▲ 1807	Inner Magnet	1	AISI 316L / CoSm	8M07810C00	6570.1	Screw	6	AISI 316	
▲ Pump Shaft				8M08810A	6570.2	Screw	4	AISI 316	
2100	Pump Shaft	1	AISI 431		6579.2	Screw	4	AISI 316	
2450	Spacer Ring	1	AISI 316		▲ Set External Screws				8M41810090000
2451	Sleeve Bearing	2	SIC		6577.1	Screw	4	AISI 304	
2500.2	Corrugated Ring	4	AISI 316		2905.1	Washer	8	AISI 304	
6700.3	Sleeve Bearings Key	1	AISI 316		6581.1	Nut	4	AISI 304	
2200	Impeller	1	ASTM CF8M	8M10820102	6577.3	Screw	2	AISI 304	
	Sleeve Bearing			8M118101	2905.4	Washer	8	AISI 304	
2451	Sleeve Bearing	2	SIC		6581.2	Nut	8	AISI 304	
2500.2	Corrugated Ring	4	AISI 316		2905.5	Washer	8	AISI 304	
Pump Shaft Only				8M12810A	6814.2	Screw	1	Carbon Steel	
2100	Pump Shaft	1	AISI 431		1806	Outer Magnet	2	AISI 304	
2450	Spacer Ring	1	AISI 316						
6700.3	Sleeve Bearings Key	1	AISI 316						
Spacer Ring				8M138101					
2450	Spacer Ring	1	AISI 316						
6700.3	Sleeve Bearings Key	1	AISI 316						
▲ 2905.3	Impeller Nut Lockwasher	1	AISI 316	8M148101					
2912	Impeller Nut	1	AISI 316	8M158101					
▲ 3051	Pump Shaft Housing	1	AISI 316	8M178101					
3134	Rear Foot	1	Steel	8M19810003					
▲ 3164	Rear Thrust Bearing	1	SIC / AISI 316	8M208101					
▲ 3165	Front Thrust Bearing	1	SIC / AISI 316	8M218101					
▲ Stationary Bearing				8M228101					
3176	Stationary Bearing	2	SIC						
2500.1	Corrugated Ring	2	AISI 316						
3870	Flushing Pipe	1	AISI 316	8M288201					
4134	Rub Ring	1	Bronze	8M398100					



NDM with self cleaning filter

- REAR WET END (RWE) = parts marked ▲
 - RECOMMENDED SPARE PARTS FOR TWO YEARS OPERATION = parts marked ■

Techno Polymers

March May offers an extremely wide range of magnetic drive pumps manufactured from a wide range of chemically resistant plastics including:

Polypropylene.
PVDF
PPS.
Acetal.
ETFE

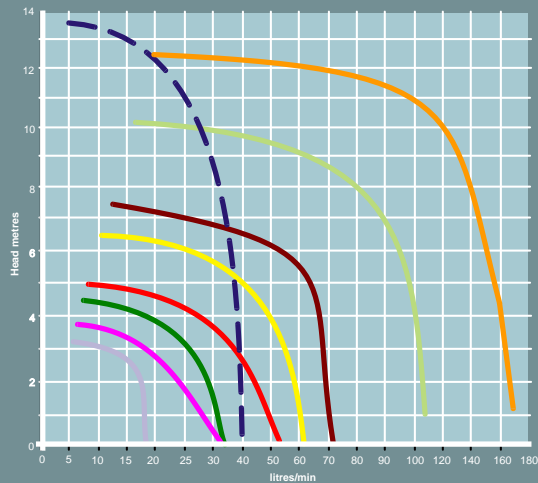

OTHER MAGNETIC DRIVE PUMPS

March May offers probably the largest range of magnetic drive pumps in the UK.



Large centrifugal
For aggressive chemicals.



ATEX rated PVDF pumps
for aggressive chemicals.



Single stage centrifugal
For milder chemicals.



Multi stage centrifugal
For mild or aggressive liquids.



Brass centrifugal
For high temperature liquids.



Single stage turbine
For mild or aggressive liquids.



Submersible centrifugal
For milder liquids.

