

Vertical Seal-less Pumps

For Aggressive Liquids

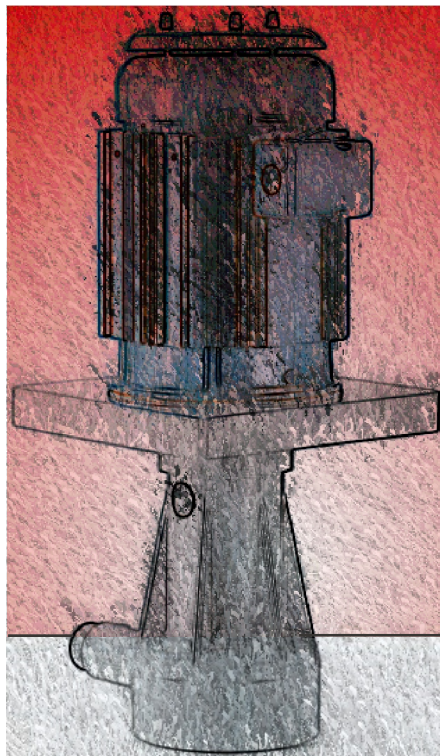

Penguin vertical immersible pumps are suitable for pumping, agitating, filtering or circulating acid and alkaline solutions (pH 0-14), abrasive fluids and other corrosive liquids.

No metal comes into contact with the liquid and no seals are utilised in the pump design.

Reliable and Long Lasting

Penguin pumps are constructed from the highest quality materials using well proven designs. They have been designed with difficult and demanding applications in mind.

Efficient and Quiet

Based on long experience their designs have been refined to minimise frictional loss to produce efficient and quiet pumps.

Mounting Plates

Purpose made mounting plates can be manufactured to suit specific applications.

Design Flexibility

Penguin pumps can be modified to suit specific and unusual applications.

Filter Systems

Penguin pumps can be combined with March May Filter Chambers to offer a range of compact and robust filtration systems.



Chemically Resistant

Due to the range of wetted materials a very wide range of acid, alkaline and solvent liquids can be pumped.

High Temperature Compatible

Penguin pumps can be configured to pump liquids up to 82°C.

Run Dry

Many Penguin models are capable of running dry.

Abrasive Particles

Penguin pumps have been designed to cope with a certain amount of abrasive particles.

Mounted Externally

Penguin pumps can be mounted on the outside of tanks.

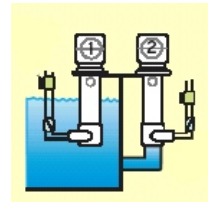

PERFORMANCE

50 Hz, SG 1.0 2900 rpm

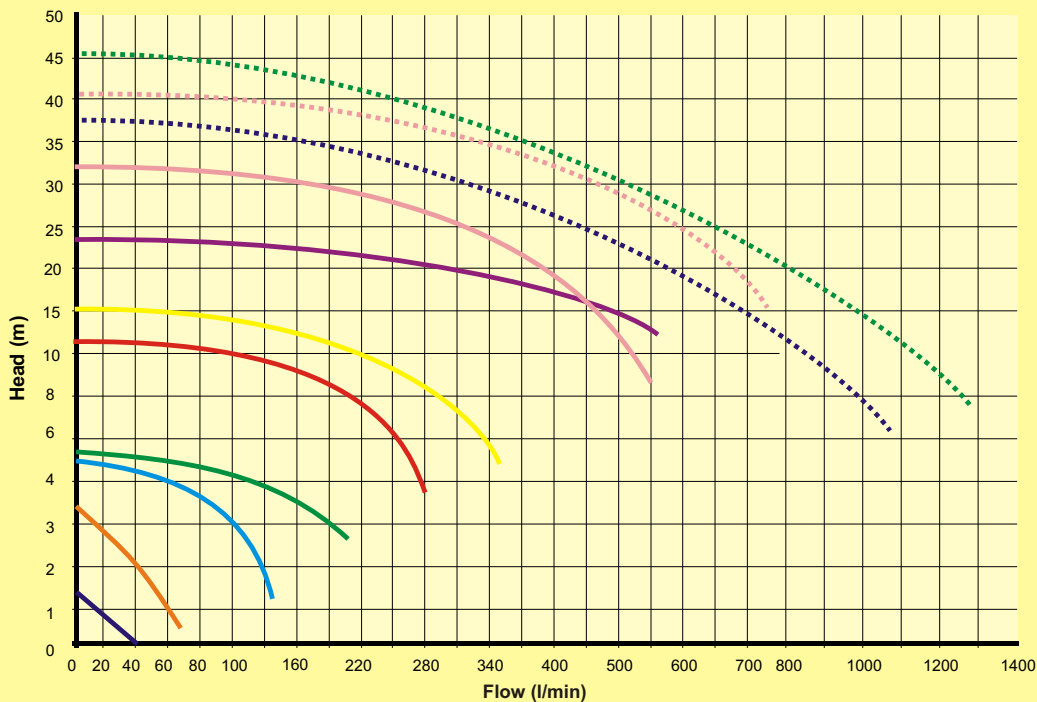

- PM 1/15
 - PM 1/6
 - PM 1/2
 - PM 3/4
 - PM 1
 - PM 2
 - PM 5
 - PM 7 1/2 6" impeller
 - PM 7 1/2 7" impeller
 - PMX 10*
 - PMX 15*
- * Approximated from 60 Hz curve

These figures are indicative, please consult March May Ltd for exact performances

DIMENSIONS

Dimensions in mm not to scale specifications are subject to change

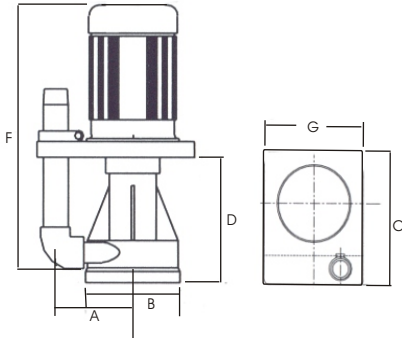

MOTORS

Penguin pumps are fitted with IP55, 415 volt CE motors as standard. In addition the following types of motors are also available.

- 230 volt single phase.
- 1 & 3 phase 60hz UL/CSA approved.
- 110 volt.
- Chemically resistant.



	A mm	B mm	C mm	D mm	E mm	F mm	G mm	Inlet size	Outlet size	Motor Kw
P 1/15	63.5	63.5	146	238	60	365	95	¾ MPT	½ FPT	0.05
P 1/6	57	82.5	165	225	38	365	102	1 FPT	¾ FPT	0.12
P 1/4	57	89	203	238	38	499	127	1 FPT	¾ FPT	0.25
PM 1/2	95	95	235	273	44.5	479	165	1 FPT	¾ FPT	0.37
PM 1/2hp	146	142	305	265	55	508	220	1½ FPT	1 MPT	0.37
PM 3/4hp	146	142	305	265	55	508	220	1½ FPT	1 MPT	0.55
PM 1	146	142	305	265	55	508	220	1½ FPT	1 MPT	0.55
PM 1 1/2	146	142	305	265	55	526	220	1½ FPT	1 MPT	0.75
PM 2	146	142	305	265	55	545	220	2 FPT	1½ MPT	1.1
PM 3	191	181	305	315	68	570	305	2 FPT	1½ MPT	2.2
PMX 3	178	181	305	525	68	918	305	2 FPT	1½ MPT	2.2
PM 5	191	181	305	315	68	570	305	2 FPT	1½ MPT	2.2
PMX 5	178	181	305	525	68	918	305	2 FPT	1½ MPT	2.2
PM 7 1/2 6"	191	235	389	315	72	725	305	2 FPT	1½ MPT	3.0
PM 7 1/2 7"	191	235	389	315	72	725	305	2 FPT	1½ MPT	5.5
PMX 7 1/2	334	235	389	540	72	1175	425	2 FPT	1½ MPT	3.0
PMX 10	334	235	389	540	72	1175	425	2 FPT	1½ MPT	7.5
PMX 15	334	235	389	540	72	1175	425	2 FPT	1½ MPT	11.0

TECHNICAL DETAILS

STANDARD COMPONENTS	Pump Body	Impeller	O Ring	Shaft
P * A	cPVC	cPVC	EPDM	316 st/steel
P * B	Polypropylene	Polypropylene	EPDM	316 st/steel
P * C	PVDF	PVDF	Viton	316 st/steel
PM * A	cPVC	cPVC	EPDM	316 st/steel
PM * B	Polypropylene	Polypropylene	EPDM	316 st/steel
PM * C	PVDF	PVDF	Viton	316 st/steel
PMX * A	cPVC	cPVC	EPDM	316 st/steel
PMX * AC	cPVC	PVDF	EPDM	316 st/steel

Titanium shafts are also available.

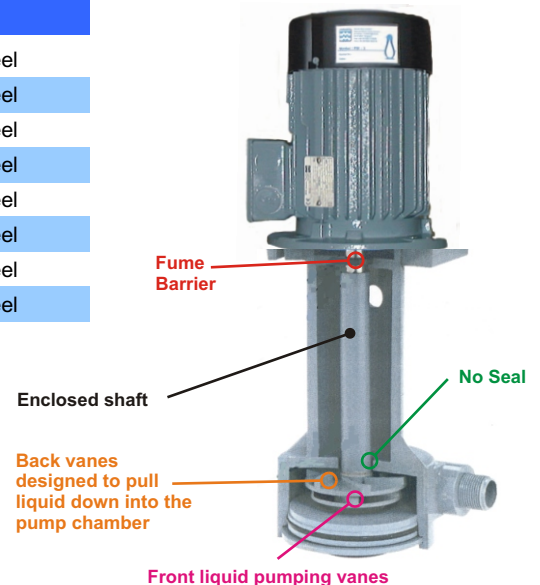

AIR-LESS AGITATION

March May offers a range of eductor agitator systems with polypropylene, PVDF and stainless steel wetted components.

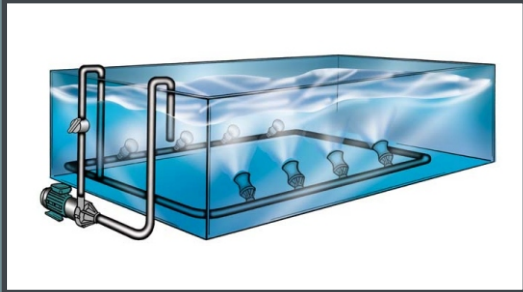

The benefits of air-less agitation are:

- Vigorous and constant agitation
- More comprehensive and thorough mixing, including tank floors.
- Reduced aeration and gas pitting.

OTHER MAGNETIC DRIVE PUMPS

March May offers probably the largest range of magnetic drive pumps in the UK.



Large centrifugal
For milder chemicals.



Compact centrifugal with
DC motors
For milder chemicals



Single stage centrifugal
For milder chemicals.



Brass centrifugal
For high temperature
liquids.



Single stage turbine
For mild or aggressive
liquids.



Submersible centrifugal
For milder liquids.



Multi stage centrifugal
For mild or aggressive
liquids.

