

# Multi-Stage Pumps

Magnetic Drive Pumps For Aggressive Chemicals

---

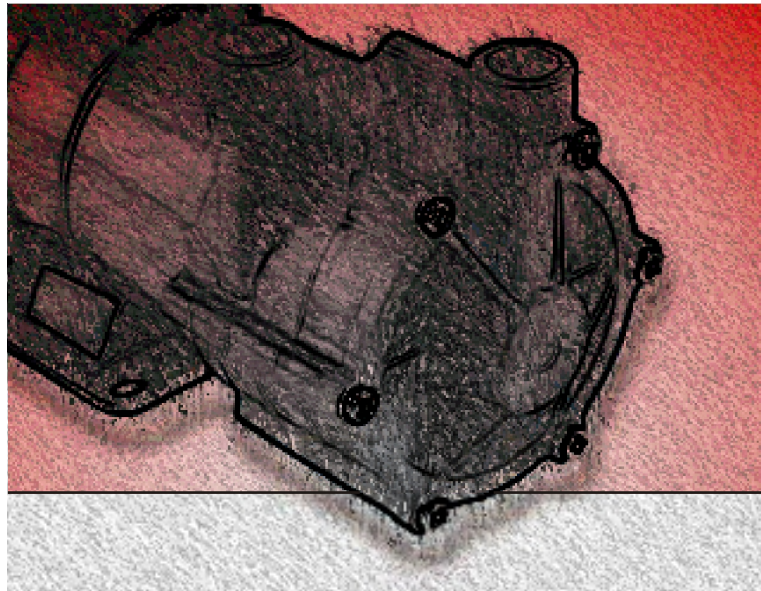

March May manufactures the largest range of small multi-stage magnetic drive pumps in the world.

They are available in a range of materials and fitted with a wide selection of motor types.

**Reliable and Long Lasting**

March May pumps are constructed from the highest quality materials using well proven designs.

**Efficient and Quiet**

Based on long experience their designs have been refined to minimise frictional loss to produce efficient and quiet pumps.

**Technical Support**

March May has built up a wealth of knowledge in the field of magnetic drive pumps over the last 30 years making us probably the most experienced such company in the UK.

**Ex-Stock**

Virtually all March May multi-stage pumps are stocked in the UK.

**Design Flexibility**

As March May also designs and manufactures pumps we possess the ability to modify and redesign our pumps to suit specific and unusual applications.

There are 4 separate ranges of pumps:

**MSP**

MSP pumps are constructed from polypropylene and fitted with a wide range of IP44 motors for pumping mild liquids.

**MS**

Manufactured from polypropylene MS pumps are designed to pump aggressive liquids and are fitted with industrial IP55 motors.

**MMP**

The MMP pump is manufactured from acetal and fitted with a wide range of IP44 motors for pumping mild liquids.

**MMP-SR**

The MMP-SR is constructed from food compatible materials.



MSP-3B-JG



MMP-3N



MS 26/14 3/4"



MSP-3A-1/2

**PERFORMANCE**

50 Hz, SG 1.0 2900 rpm

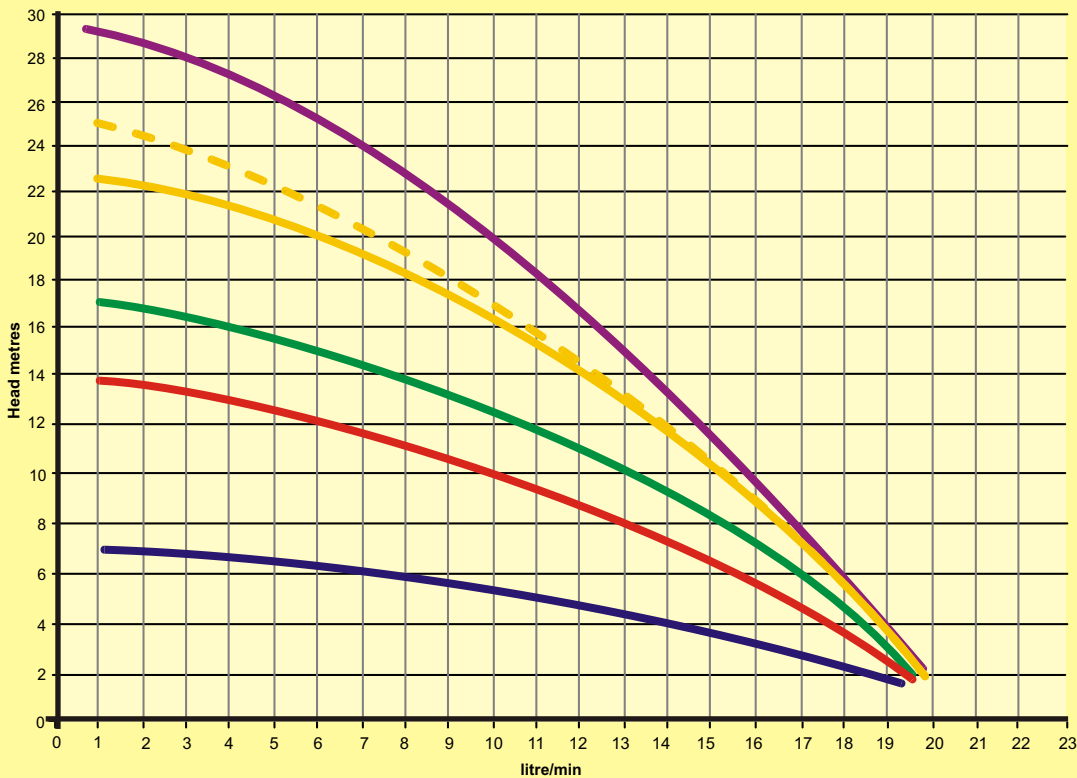

- 5 Stage
- 4 Stage Hi Power
- 4 Stage
- 3 Stage
- 2 Stage
- 1 Stage



All March May plastic impellers can be trimmed at no extra cost to cater for higher SGs, viscous liquids and 60Hz.

These figures are indicative, please consult march May Ltd for exact performances

## DIMENSIONS

Dimensions in mm not to scale

specifications are subject to change

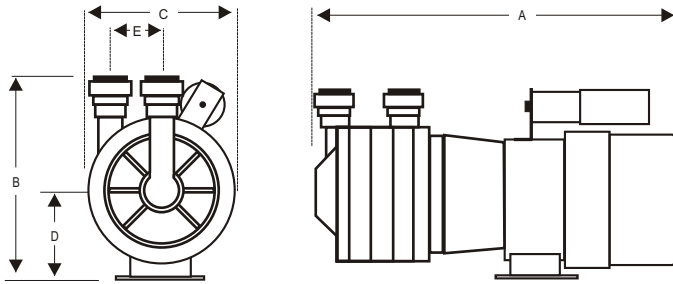

## MOTORS

Our multi stage pumps are fitted with IP55, 415 or 230 volt CE motors as standard. In addition the following types of motors are also available.

- 1 & 3 phase 60hz UL/CSA.
- Dual voltage.
- Dual frequency.
- Chemically resistant.
- Brushed & Brush-less DC.

Model	A mm	B mm	C mm	D mm	E mm	Inlet Ports	Outlet Ports	Motor Kw	amps 230 v	amps 415 v	Alternative Motors			
											UL/CSA	50/60hz	shaded P	24v DC
<b>MSP-1</b>	207	136	114	56	40.5	15mm, 3/4" or 1/2"NPT.M	15mm, 3/4" or 1/2"NPT.M	0.03	0.42					
<b>MSP-2</b>	263	152	114	56	40.5	15mm, 3/4" or 1/2"NPT.M	15mm, 3/4" or 1/2"NPT.M	0.07	0.70					
<b>MSP-3</b>	281	152	114	56	40.5	15mm, 3/4" or 1/2"NPT.M	15mm, 3/4" or 1/2"NPT.M	0.09	0.90					
<b>MSP-4</b>	325	154	114	56	40.5	15mm, 3/4" or 1/2"NPT.M	15mm, 3/4" or 1/2"NPT.M	0.12	0.92					
<b>MSP-4 hp</b>	347	154	114	62	40.5	15mm, 3/4" or 1/2"NPT.M	15mm, 3/4" or 1/2"NPT.M	0.18	1.10					
<b>MSP-5</b>	362	154	114	62	40.5	15mm, 3/4" or 1/2"NPT.M	15mm, 3/4" or 1/2"NPT.M	0.18	1.10					
<b>MS 7/12</b>	268	152	144	56	40.5	15mm, 3/4" or 1/2"NPT.M	15mm, 3/4" or 1/2"NPT.M	0.11	0.92	0.34				
<b>MS 13/13</b>	285	152	144	56	40.5	15mm, 3/4" or 1/2"NPT.M	15mm, 3/4" or 1/2"NPT.M	0.11	0.92	0.34				
<b>MS 20/13</b>	303	152	144	56	40.5	15mm, 3/4" or 1/2"NPT.M	15mm, 3/4" or 1/2"NPT.M	0.11	0.92	0.34				
<b>MS 26/14</b>	321	152	144	56	40.5	15mm, 3/4" or 1/2"NPT.M	15mm, 3/4" or 1/2"NPT.M	0.11	0.92	0.34				
<b>MMP-1</b>	207	234	114	56	40.5	3/8" BSP.F	3/8" BSP.F	0.03	0.42					
<b>MMP-2</b>	263	243	114	56	40.5	3/8" BSP.F	3/8" BSP.F	0.07	0.70					
<b>MMP-3</b>	281	234	114	56	40.5	3/8" BSP.F	3/8" BSP.F	0.09	0.9					
<b>MMP-4</b>	325	175	114	56	40.5	3/8" BSP.F	3/8" BSP.F	0.12	0.92					

## TECHNICAL DETAILS

March May carries out all moulding in house, therefore a wide range of alternative plastics can be used in the construction of our multi-stage pumps.

EPDM and PTFE O rings can also be fitted.

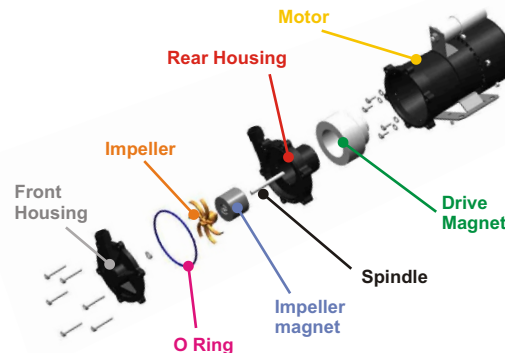

	Pump Housing	Impeller	Impeller Magnet	Spindle	O Ring
<b>MSP-1/sp</b>	Polypropylene	Ryton	Stront Ferrite	St Steel	Nitrile
<b>MSP-1</b>	Polypropylene	Ryton	Stront Ferrite	St Steel	Nitrile
<b>MSP-2</b>	Polypropylene	Ryton	Stront Ferrite	St Steel	Nitrile
<b>MSP-3</b>	Polypropylene	Ryton	Stront Ferrite	St Steel	Nitrile
<b>MSP-4</b>	Polypropylene	Ryton	Stront Ferrite	St Steel	Nitrile
<b>MSP-5</b>	Polypropylene	Ryton	Stront Ferrite	St Steel	Nitrile
<b>MS 7/12</b>	Polypropylene	Ryton	Polypropylene	Ceramic	Viton
<b>MS 13/13</b>	Polypropylene	Ryton	Polypropylene	Ceramic	Viton
<b>MS 20/13</b>	Polypropylene	Ryton	Polypropylene	Ceramic	Viton
<b>MS 26/14</b>	Polypropylene	Ryton	Polypropylene	St Steel	Viton
<b>MMP-1</b>	Acetal	Ryton	Stront Ferrite	St Steel	Nitrile
<b>MMP-2</b>	Acetal	Ryton	Stront Ferrite	St Steel	Nitrile
<b>MMP-3</b>	Acetal	Ryton	Stront Ferrite	St Steel	Nitrile
<b>MMP-4</b>	Acetal	Ryton	Stront Ferrite	St Steel	Nitrile
<b>MMP-1/SR</b>	Natural Acetal	Ryton	Stront Ferrite	St Steel	Nitrile FQ
<b>MMP-2/SR</b>	Natural Acetal	Ryton	Stront Ferrite	St Steel	Nitrile FQ
<b>MMP-3/SR</b>	Natural Acetal	Ryton	Stront Ferrite	St Steel	Nitrile FQ
<b>MMP-4/SR</b>	Natural Acetal	Ryton	Stront Ferrite	St Steel	Nitrile FQ

## PORT CONFIGURATIONS

Shown below are the standard port configurations for the multi-stage pumps.

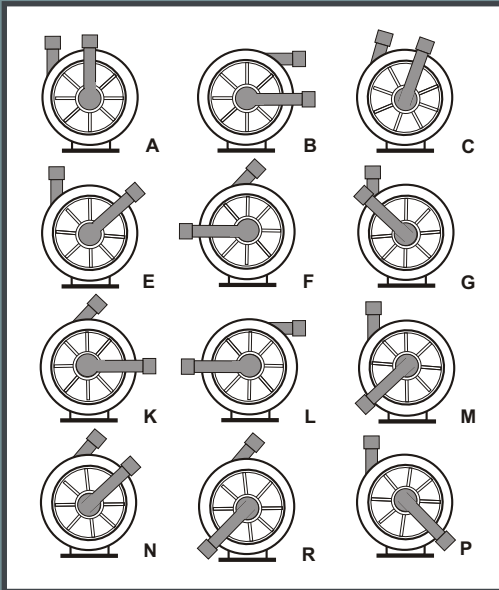

Please consult us if you are considering any other port configuration.

## OTHER MAGNETIC DRIVE PUMPS

March May offers probably the largest range of magnetic drive pumps in the UK.



Large centrifugal  
For milder chemicals.



Compact centrifugal with  
DC motors  
For milder chemicals



Single stage centrifugal  
For milder chemicals.



Brass centrifugal  
For high temperature  
liquids.



Single stage turbine  
For mild or aggressive  
liquids.



Submersible centrifugal  
For milder liquids.



Vertical multi stage  
centrifugal.



Vertical single stage  
turbine.



March May Ltd, Howard Road, Eaton Socon, St Neots PE19 8NZ, England

Tel: +44 (0) 1480 214444 Fax: +44 (0) 1480 405336 E-Mail: sales@marchmay.co.uk Website: www.marchmay.co.uk