

AC, LC & MDX PUMPS

Magnetic Drive Pumps For Mild Liquids

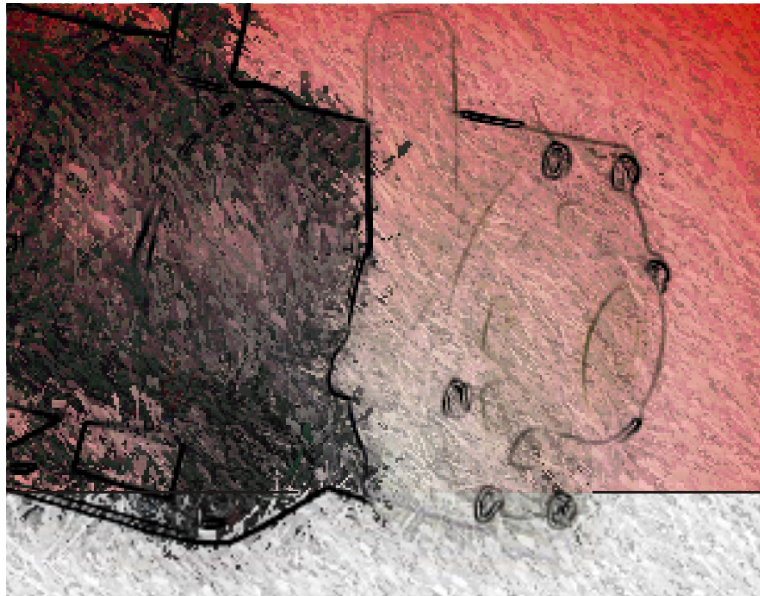

March May specializes in the design and manufacture of seal-less magnetic drive centrifugal pumps for OEM applications.

Many of the AC and LC pump designs have seen over 30 years service in a multitude of applications around the world.

Reliable and Long Lasting

Friction has been significantly reduced and with no seals, liquid cannot seep into the motor from the pump.

No Heat Transfer from Motor

The pump chamber is separated from the motor by an air gap, this provides a thermal barrier.

Efficient and Quiet

Power wasted through frictional loss is significantly reduced which produces an efficient and quiet pumping process.

Easily Maintained

The pump head can be easily dis-assembled and components quickly replaced.

Ex-Stock

Virtually all models are stocked in the UK.

Built-in Overload Protection

If overloaded, the magnetic coupling breaks drive to provide protection for the motor from burn-out.

Design Flexibility

As March May also designs and manufactures pumps we possess the ability to modify and redesign pumps to suit specific and unusual applications.

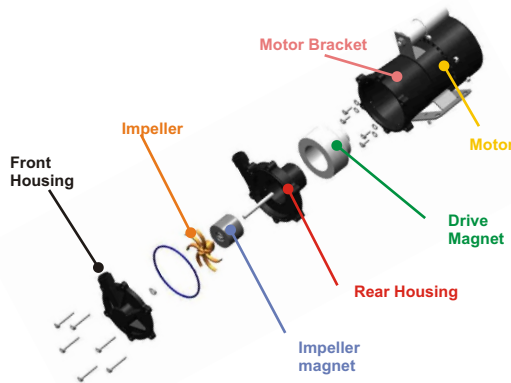

AC-5P-MD



MDX 1/2"



LC-3CP-MD



AC-1A

PERFORMANCE

50 Hz, SG 1.0 2900 rpm

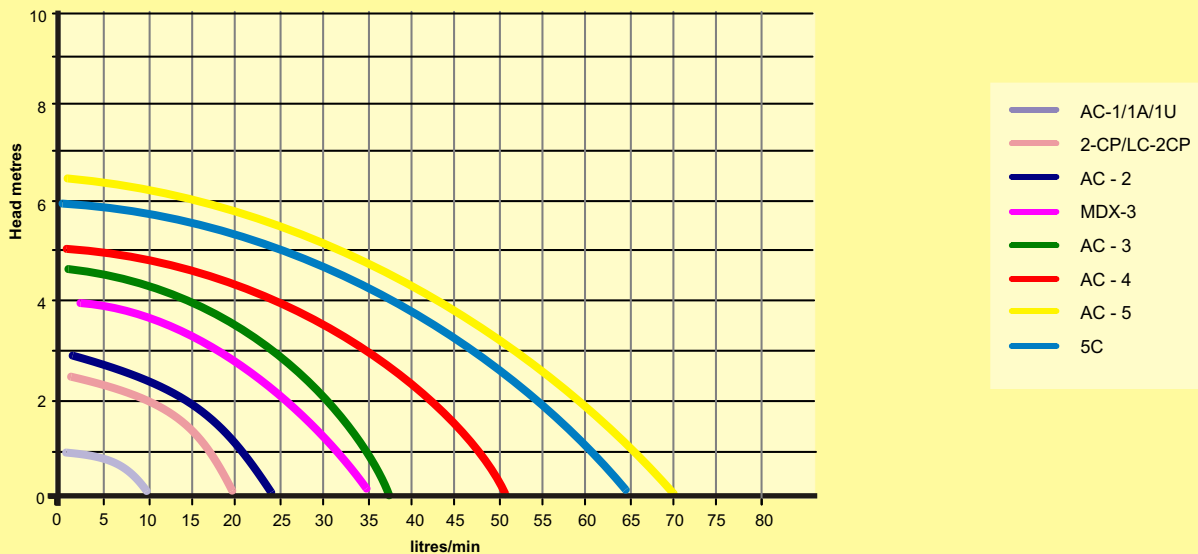

All March May plastic impellers can be trimmed at no extra cost to cater for higher SGs, viscous liquids and 60Hz

These figures are indicative, please consult March May Ltd for exact performances.

DIMENSIONS

Dimensions in mm not to scale

specifications are subject to change

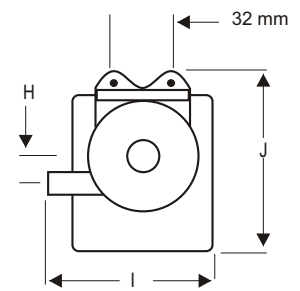
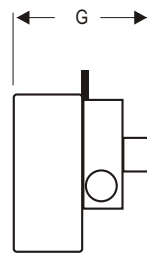
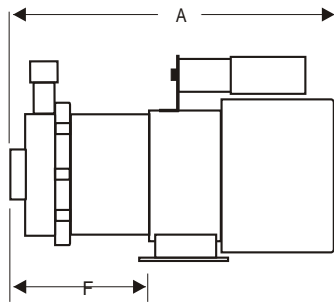
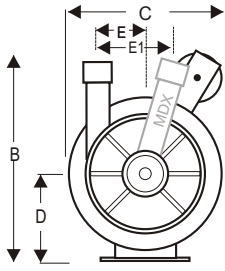

Model	Motor Type	A mm	B mm	C mm	D mm	E mm	F mm	G mm	H mm	I mm	Inlet Ports	Outlet Ports	Motor Kw	amps 230 v
AC-1A-MD	AC							109	12.5	92	1/2" OD	1/2" OD	0.013	0.15
AC-1C-MD	AC							109	12.5	92	1/4"NPT.M	1/4"NPT.M	0.013	0.15
1A-MD	sub							113	12.5	99.5	3/8", 1/2" OD	3/8", 1/2" OD	0.013	0.15
1U-MD	sub							113	12.5	99.5	1/4"NPT.M	1/4"NPT.M	0.013	0.15
MDXT-3	AC	244	152	144	56	29	110/113				1/2" NPT.F	3/8" NPT.F	0.03	0.15
MDX-3	AC	244	152	144	56	29	110/113				1/2" OD, 5/8" OD	1/2" OD, 5/8" OD	0.03	0.15
AC-2CP-MD/UE	AC	188	136	89	57	21	49				3/8"NTP.F, 3/4"NPT.M	1/4" NPT.M	0.03	0.15
LC-2CP-MD	sub	156	105	119	46	21.5	39				3/8"NTP.F, 3/4"NPT.M	1/4" NPT.M	0.54	0.57
2CP-MD	sub	156	105	119	46	21.5	39				3/8"NTP.F, 3/4"NPT.M	1/4" NPT.M	0.03	0.15
AC-3P-MD	AC	244	152	144	56	29	57				3/4"BSP.F	1/2"NPT.M	0.03	0.15
AC-3D-MD	AC	244	152	144	56	29	57				3/4"BSP.F	1/2"NPT.M	0.03	0.15
AC-3CP-MD	AC	244	152	144	56	29	57				3/4"BSP.F	1/2"NPT.M	0.03	0.15
LC-3CP-MD	sub	187	123	123	53	28.5	34				3/4"BSP.F	1/2"NPT.M	0.1	0.79
AC-4P-MD	AC	242	152	144	56	29	63				1/2"NPT.M	1/2"NPT.M	0.07	0.70
AC-4R-MD	AC	242	152	144	56	29	63				1/2"NPT.M	1/2"NPT.M	0.07	0.7
AC-5P-MD	AC	252	154	144	56	32	63				1"BSP.F	1/2"NPT.M	0.07	0.7
AC-5R-MD	AC	252	154	144	56	32	63				1"BSP.F	1/2"NPT.M	0.07	0.7
LC-5C-MD	sub	249	179	138	76	32					1"BSP.F	1/2"NPT.M	0.149	1

TECHNICAL DETAILS

Model	Pump Housing	Impeller	O Ring	Shaft	Other Wetted Mats When submerged	Max Liquid Temp °C
AC-1A-MD	Polypropylene	Nylon/Ceramic	Buna N	st/steel		87
AC-1C-MD	Polypropylene	Nylon/Ceramic	Buna N	st/steel		87
1A-MD	Polypropylene	Nylon/Ceramic	Buna N	st/steel	Noryl, Epoxy, SJT cord	87 sub 71
1U-MD	Polypropylene	Polypropylene/Ceramic	Buna N	st/steel	Noryl, Epoxy, SJT cord	87 sub 71
MDXT-3	Polypropylene	Polypropylene/Ceramic	Buna N	Ceramic		87
MDX-3	Polypropylene	Polypropylene/Ceramic	Buna N	Ceramic		87
AC-2P-MD	Polypropylene	Polypropylene/Ceramic	Viton	Ceramic		87
LC-2CP-MD	Polypropylene	Polypropylene/Ceramic	Viton	Ceramic	Noryl, Epoxy, SJT cord	54
AC-2CP-MD	Polypropylene	Polypropylene/Ceramic	Viton	Ceramic		87
AC-3P-MD	Polypropylene	Polypropylene/Ceramic	Nitrile	Ceramic		87
AC-3D-MD	Delrin	Delrin/Ceramic	Nitrile	Ceramic		87
LC-3CP-MD	Polypropylene	Polypropylene/Ceramic	Buna N	Ceramic	Polysufil, Epoxy,	54
AC-4P-MD	Polypropylene	Polypropylene/Ceramic	Nitrile	Ceramic		87
AC-4R-MD	Ryton	Ryton/Ceramic	Nitrile	Ceramic		93
AC-5P-MD	Polypropylene	Polypropylene/Ceramic	Nitrile	Ceramic		87
AC-5R-MD	Polypropylene	Polypropylene/Ceramic	Nitrile	Ceramic		87
5C-MD	Polypropylene	Polypropylene/Ceramic	Buna N	Ceramic	Noryl, Epoxy, SJT cord	54
LC-5C-MD	Polypropylene	Polypropylene/Ceramic	Buna N	Ceramic	Noryl, Epoxy, SJT cord	54



893 DC PUMPS

893 pumps are compact and extremely reliable magnetically driven pumps for use in situations where space is at a premium.

Manufactured from resistant plastics and stainless steel.
 Available with a range of 12 or 24 volt DC motors.
 Will fit into confined spaces.
 Will withstand temperatures up to 90°C .
 Minimal heat transfer from the motor into chilled liquids.
 Extremely quiet.
 Reliable and long lasting.
 Easy to service.
 Manufactured from food grade materials.

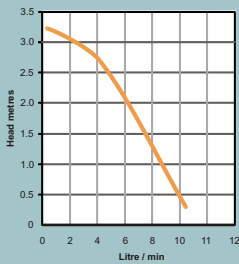

Inlet Port: 3/8" FPT
Outlet Port: 3/8" OD
Motor Power: 11 Watts

Motor Life: Brush-less 50,000 hrs.
 Brushed 3,000 hrs.

Wetted Components:
 Noryl, ceramic, Teflon, Stainless Steel, Buna

OTHER PUMPS

March May offers probably the largest range of magnetic drive pumps in the UK.



Large centrifugal
 For aggressive chemicals.



Multi stage centrifugal
 For mild or aggressive liquids.



Brass centrifugal
 For high temperature liquids.



Single stage turbine
 For mild or aggressive liquids.



Vertical multi stage centrifugal.



Vertical single stage turbine.

