



TE-4 RANGE

01/01/2011

DIMENSIONAL SCHEMATIC, PERFORMANCE AND PARTS

PARTS LIST

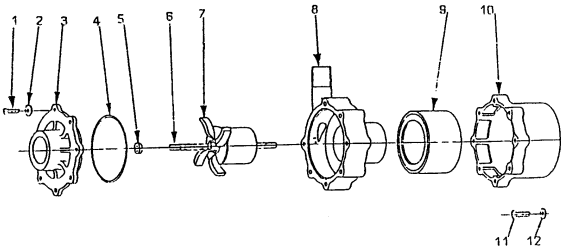

ITEM	DESCRIPTION	NOS	CODE	PRICE
TE-4S-MD				
1	HOUSING SCREWS ST/STEEL	7	0150-101-UK	£ 3.85
2	HOUSING WASHERS ST/STEEL	7	0150-200-UK	£ 0.91
3	COVER ST/STEEL	1	0150-111-00	£ 287.68
4	'O' RING PTFE	1	0135-136-UK	£ 18.02
5	THRUST WASHER	1	130-028-UK	£ 4.97
6	SPINDLE ST/ST	1	5021-230-51	£ 12.54
7	IMPELLER ASSY ST/ST 2.75"	1	0150-114-04	£ 733.30
7a	CARBON BUSHING	1	0150-063-10	£ 29.07
8	PUMP HOUSING ST/STEEL	1	0150-110-00	£ 426.18
9	DRIVE MAGNET (9mm) HIGH TORQUE		0150-178-01	£ 130.80
10	MOTOR BRACKET C/W INSERTS	1	0001-051-UK	£ 38.36
11	BRACKET FIXING SCREWS	4	0130-100-UK	£ 1.40
12	BRACKET FIXING WASHERS	4	0135-200-UK	£ 1.40
	WET END ASSY ITEMS 1-8		0040-555-21	£ 1,516.52
	PUMP HEAD ASSY ITEMS 1-12		P040-555-213	£ 1,688.48

DIMENSIONS mm

not to scale specifications are subject to change

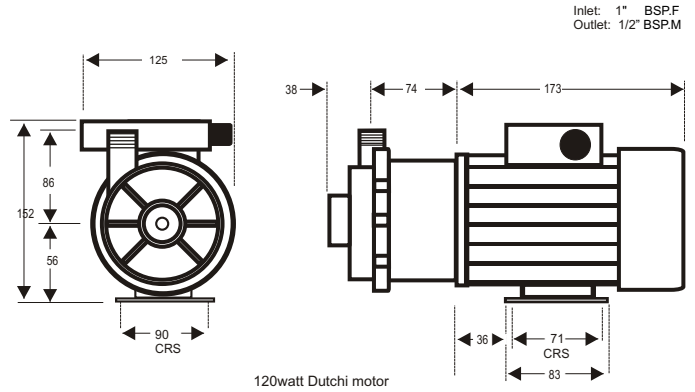

Details may change depending upon the motor specified

PERFORMANCE

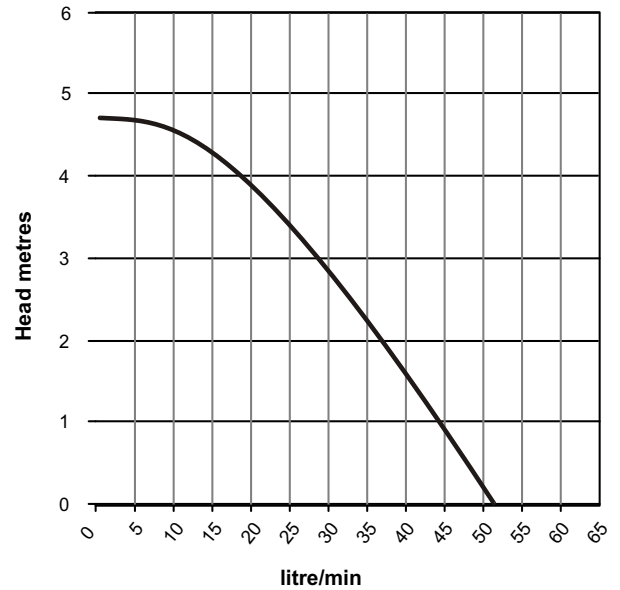

Tests obtained with water 1.0 SG

— 50 hz 2900 rpm