



# TE-3 RANGE

01/01/2011

## DIMENSIONAL SCHEMATIC, PERFORMANCE AND PARTS

### PARTS LIST

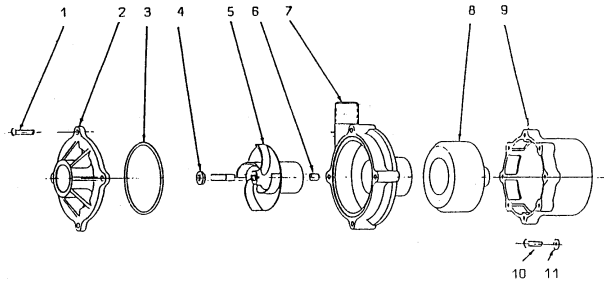

| ITEM DESCRIPTION             | NOS | CODE         | PRICE    |
|------------------------------|-----|--------------|----------|
| <b>TE-3K-MD</b>              |     |              |          |
| 1 HOUSING SCREW ST/STEEL     | 4   | 5090-910-50  | £ 4.12   |
| 2 PUMP COVER KYNAR           | 1   | 0130-111-10  | £ 39.20  |
| 3 'O' RING VITON             | 1   | 0130-033-UK  | £ 5.80   |
| 4 THRUST WASHER CERAMIC      | 1   | 0130-028-UK  | £ 5.22   |
| 5 ENCAPSULATED IMPELLER ASSY | 1   | 0130-112-02  | £ 127.76 |
| 6 SPINDLE CERAMIC            | 1   | 0130-024-UK  | £ 13.17  |
| 7 PUMP HOUSING KYNAR         | 1   | 0130-110-10  | £ 48.89  |
| 8 DRIVE MAGNET ASSY (9mm)    | 1   | 0750-254-00  | £ 46.94  |
| 9 MOTOR BRACKET              | 1   | 0001-030-UK  | £ 30.37  |
| 10 BRACKET FIXING SCREWS     | 4   | 0130-100-UK  | £ 1.48   |
| 11 BRACKET FIXING WASHERS    | 4   | 0135-200-UK  | £ 1.48   |
| WET END ASSY ITEMS 1-7       |     | 0030-333-01  | £ 241.50 |
| PUMP HEAD ASSY ITEMS 1-11    |     | P030-333-012 | £ 321.75 |

### TE-3P-MD

|                           |   |              |          |
|---------------------------|---|--------------|----------|
| 1 HOUSING SCREWS          | 4 | 5090-910-50  | £ 4.12   |
| 2 PUMP COVER POLYPRO      | 1 | 0130-021-10  | £ 9.91   |
| 3 'O' RING VITON          | 1 | 0130-033-UK  | £ 5.80   |
| 4 THRUST WASHER CERAMIC   | 1 | 0130-028-UK  | £ 5.22   |
| 5 ENCAPSULATED IMP ASSY   | 1 | 0130-069-02  | £ 70.40  |
| 6 SPINDLE CERAMIC         | 1 | 0130-024-UK  | £ 13.17  |
| 7 PUMP HOUSING POLYPRO    | 1 | 0130-018-10  | £ 14.34  |
| 8 DRIVE MAGNET ASSY (9mm) | 1 | 0750-254-00  | £ 46.94  |
| 9 MOTOR BRACKET           | 1 | 0001-030-UK  | £ 30.37  |
| 10 BRACKET FIXING SCREWS  | 4 | 0130-100-UK  | £ 1.48   |
| 11 BRACKET FIXING WASHERS | 4 | 0135-200-UK  | £ 1.48   |
| WET END ASSY ITEMS 1-7    |   | 0030-111-01  | £ 120.31 |
| PUMP HEAD ASSY ITEMS 1-11 |   | P030-111-012 | £ 200.56 |

### DIMENSIONS mm

not to scale specifications are subject to change

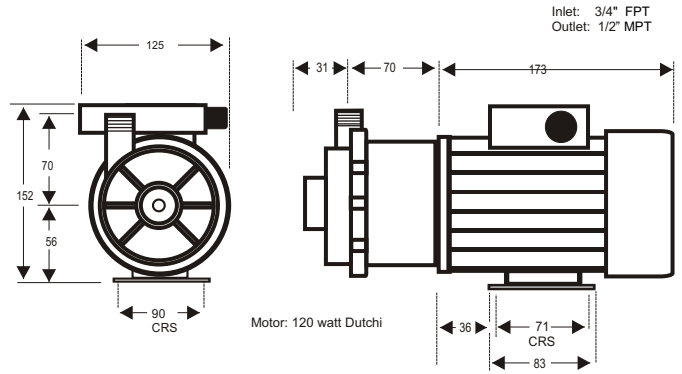

Details may change depending upon the motor specified

### PERFORMANCE

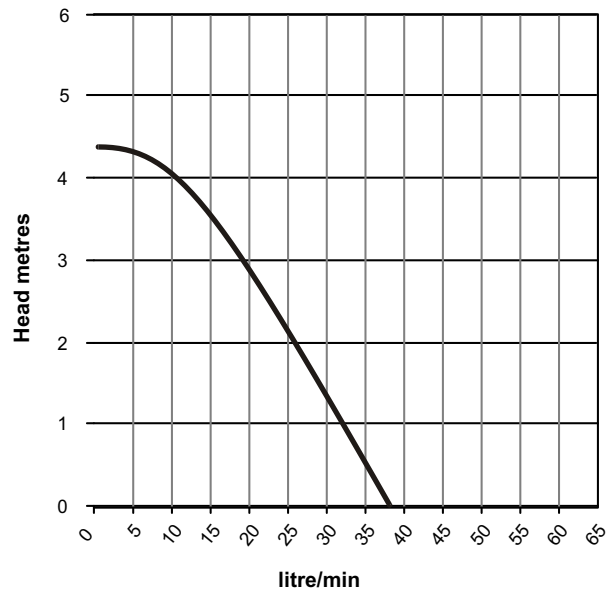

Tests obtained with water 1.0 SG

— 50 hz 2900 rpm